

Universal Gateway

The SALUS Smart Home gateway is what connects your SALUS iT600 Smart Home devices together and when connected to any WIFI router allows control via Smartphone, Tablet or PC, using the SALUS Smart Home app.



Features

- LED indication
- Connects all SALUS iT600 Smart Home products to the Smart Home app
- Ethernet connection



 **SALUS**
CONTROLS

www.salus-smarthome.com

Smart Home App

The Smart Home App available on IOS and Android. With easy to use functions and simple to add heating schedules. It is easy to control your individual products settings and heating from anywhere via Smartphone, Tablet or PC using your existing router.

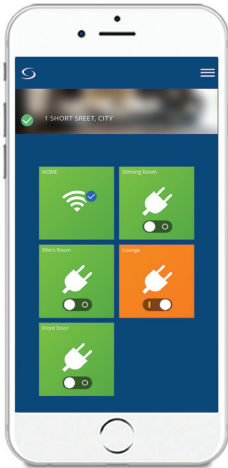

Easy to install and control.

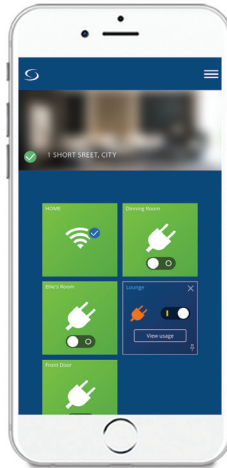

Simply click ON or OFF.

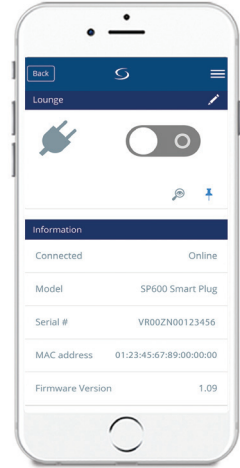

Quick and easy to add schedules.

Technical information

Product name	Universal Gateway
User Interface	One Multifunction button
Indication	Bi Colour LED - RED - GREEN
Port	1 x 10/100 LAN port
Power Supply	5V DC through USB (1m Detachable Micro USB to Type A cable) by power adaptor
Housing Material	PC241R
Mounting	Table or wall mounted
Colour	White
Finishing	Matte white fine finish
IP Rating	IP30
Protection	Rohs-2, REACH, WEEE
Frequency	2,4Ghz Zigbee HA1.2
Operating Temperature	0-50 C
Storage Temperature	-10-60 C
Operating Humidity	5-90% RH
Approval I	CE; R&TTE